

**A FULL STEP
INTO
A FULL HD ERA!**



2 -LINE IP
cameras

Key Features

* Product picture and technical specs subject to change without previous notice. For further information, please contact our local sales representatives.



- Automatic WiFi connection
- Simplified management
- Easy remote access via Wi-Fi

HD IP Wi-Fi Kit

Both versatile and advanced, Hikvision's HD IP Wi-Fi Kit is a combination designed for the needs of a home, office, store, or other small-to-medium sized enterprise. Including a 2-Line Wi-Fi IP camera and a DS-7104 series NVR, this set allows the user to monitor their home or business through a simple connection that requires no networking knowledge or previous wiring installation. This camera & NVR combo establishes an instant connection to begin video recording right away. Never before has it been so easy to set-up a network video surveillance system!



Full HD Resolution

You never have to guess what's going on at your place - day or night - with our cameras. Offering improved sharpness, clarity, and larger FoV under all light conditions, the cameras capture detailed video footage any time, all the time.



Highly Efficient Encoding

Based on Hikvision's latest codec algorithm, the cameras offer a higher compression efficiency of about 30% ~ 50% over conventional network cameras, thereby reducing the burden of transmission and storage on the IP surveillance system.

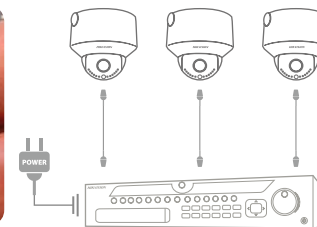

Plug & Play

Configuring the IP system is a breeze. By simply plugging a CAT5 cable into the network interface of Hikvision's embedded PoE NVR, the camera's IP address is automatically detected and configured to transmit a live view and to store video. Additionally, it eliminates the cumbersome power cable deployment.



Line Crossing Detection

This function can detect objects such as persons or vehicles crossing (enter/exit) a defined virtual field.



Intrusion Detection

In the case of intrusion detection, the 2-line camera simultaneously auto-triggers the alarm and event recording. These features are extremely beneficial for pre-defined area protection.



DWDR

DWDR functionality is incorporated to help capture clear images in strongly-lit and/or high-contrast environments, without compromising image quality or color accuracy.



Onboard Storage

Up to a 64GB SD, SDHC, or SDXC card is supported in order to store important data if the network should become disconnected.

Key Features



3D DNR

By taking advantage of Hikvision's advanced ISP (Imaging Signal Processing) technology, 2-Line IP cameras are able to deliver crystal-clear image quality in low light conditions without any increase in image noise.

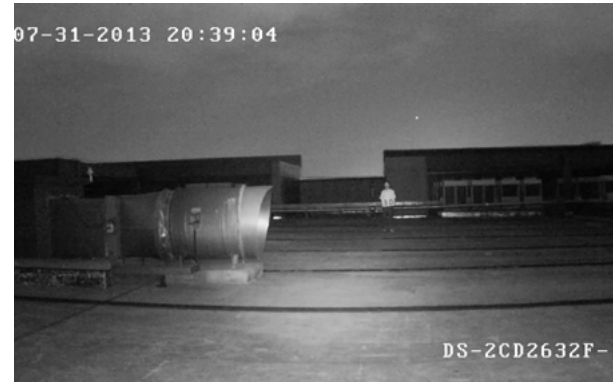

Excellent IR Range

The 2-line IP cameras come with high-performing IR LEDs to deliver outstanding nighttime monitoring with long-range visibility of up to 80 meters.



True IP66

Outdoor cameras with true IP66-rated housing protect themselves from rain or dust damage in rugged environments. The cameras are enclosed in a scratch-resistant, waterproof aluminum casing that incorporates multiple seals.



Wi-Fi with WPS connection

Using the WPS (Wi-Fi Protected Setup) feature, the wireless models can read the wireless router's configuration in an easier and more secure way.



EXIR Technology

The cameras incorporating Hikvision's EXIR infrared array technology provide best-in-breed illumination for any low- or zero-light environment. Benefiting from a highly efficient light source and a revolutionary rectangular lens for seamless HD formatting, the EXIR cameras deliver the most advanced levels of nighttime surveillance available on the market today.



EZVIZ Cloud - P2P

All the Hikvision 2-Line network cameras support EZVIZ Cloud - P2P service to easily realize a distance access through a simple phone scanning of supplied on-product QR code.



Compact Design

Some of the 2-line cameras include housing that's small enough to fit in the palm of one's hand. This is ideal for locations that require a more discreet aesthetic.



Configurable BLC

This allows the camera to optimize the light levels of the specific area to properly expose the object in a scenario with very strong back light.



Economic Panorama Solution

Hikvision will introduce its newest 4MP fisheye network camera which brings up a new affordable panoramic solution to SMB market, such as small sized shop, convenience store etc.



DS-2CD2022-I (2.0MP)

DS-2CD2032-I (3.0MP)

IR Mini Bullet Network Camera

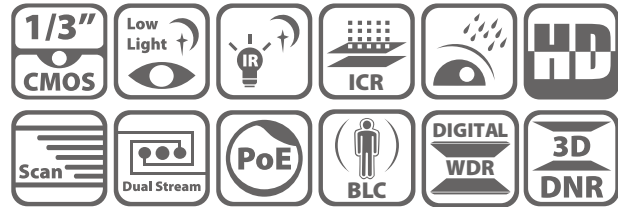

Key features

- 2MP / 3MP high resolution
- HD real-time video
- 3D DNR & DWDR & BLC
- IR LEDs: up to 30m
- IP66
- PoE
- Compact design
- Bracket included

Dimensions

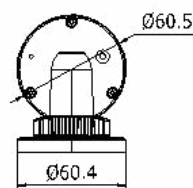
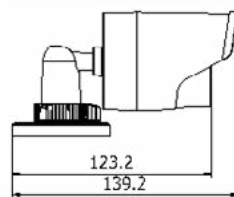
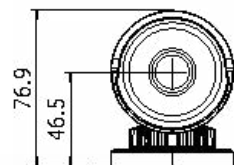

Unit: mm

Available models

DS-2CD2022-I (2.0MP)

DS-2CD2032-I (3.0MP)

* 1.3MP model is also available -- DS-2CD2012-I

	DS-2CD2022-I	DS-2CD2032-I
Camera		
Image sensor	1/3" progressive scan CMOS	
Min. illumination	0.01 lux @F1.2, AGC ON, 0 lux with IR	0.07 lux @F1.2, AGC ON, 0 lux with IR
Shutter time	1/3s ~ 1/100,100s	
Lens	4mm @ F2.0 (6mm optional) Angle of view: 79°(4mm), 49°(6mm)	4mm @ F2.0 (6mm optional) 1920 × 1080: Angle of view: 79°(4mm), 49°(6mm) 2048 × 1536: Angle of view: 70°(4mm),43.3°(6mm)
Lens mount	M12	
Day & night	ICR	
Digital noise reduction	3D DNR	
Wide dynamic range	Digital WDR	
Compression Standard		
Video compression	H.264 / MJPEG	
H.264 codec profile	Main profile	
Bit rate	32 Kbps ~ 16 Mbps	
Dual stream	Yes	
Image		
Max. Image Resolution	1920 x 1080	2048 x 1536
Frame rate	50Hz: 25fps (1920 × 1080), 25fps (1280 × 720) 60Hz: 30fps (1920 × 1080), 30fps (1280 × 720)	50Hz: 20fps (2048 × 1536), 25fps (1920 × 1080), 25fps (1280 × 720) 60Hz: 20fps (2048 × 1536), 30fps (1920 × 1080), 30fps (1280 × 720)
Image settings	Saturation, brightness, sharpness, contrast, sharpness adjustable through client software or web browser	
BLC	Yes, zone configurable	
Network		
Network storage	NAS	
Alarm trigger	Motion detection, line crossing detection, tampering alarm, scene change detection, face detection, intrusion detection	
Protocols	TCP/IP, ICMP, HTTP, HTTPS, FTP, DHCP, DNS, DDNS, RTP, RTSP, RTCP, PPPoE, NTP, UPnP, SMTP, SNMP, IGMP, 802.1X, QoS, IPv6, Bonjour	
System compatibility	ONVIF, PSIA, CGI	
General functionalities	User Authentication, watermark, reset button	
Interface		
Communication interface	1 RJ45 10 M / 100 M Ethernet interface	
General		
Operating conditions	-30 °C ~ 60 °C (-22°F ~ 140 °F) humidity 95% or less (non-condensing)	
Power supply	12 VDC ± 10% , PoE (802.3af)	
Power consumption	Max. 5W (max. 7W with ICR on)	
Weather proof rating	IP66	
IR range	Up to 30m	
Dimension	60.4 x 76.9 x 139.2mm	
Weight	500g	

DS-2CD2122F-I(S)(W) (2.0MP)

DS-2CD2132F-I(S)(W) (3.0MP)

IR Fixed Dome Network Camera

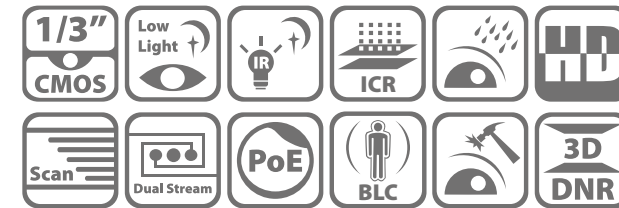

Key features

- 2MP / 3MP high resolution
- HD real-time video
- 3D DNR & DWDR & BLC
- IR LEDs: up to 30m
- IP66
- Vandal-proof
- PoE
- Onboard storage (up to 64GB)
- Wi-Fi optional

Dimensions

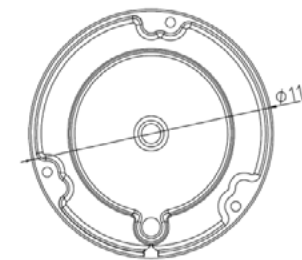
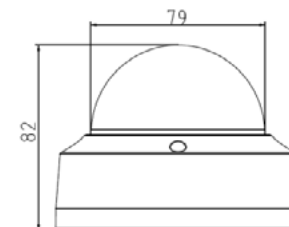

Available models

2.0MP:

DS-2CD2122F-I, DS-2CD2122F-IS,

DS-2CD2122F-IW, DS-2CD2122F-IWS

3.0MP:

DS-2CD2122F-I, DS-2CD2122F-IS,

DS-2CD2122F-IW, DS-2CD2122F-IWS

* 1.3MP model is also available -- DS-2CD2112F-I

* -S: Audio I/O interface, Alarm I/O interface.

-W: Built-in Wi-Fi

	DS-2CD2122F-I(S)(W)	DS-2CD2132F-I(S)(W)
Camera		
Image sensor	1/3" Progressive Scan CMOS	
Min. illumination	0.01 lux@F1.2, AGC ON, 0 lux with IR	0.07Lux @F1.2, AGC ON, 0 lux with IR
Shutter time	1/3s ~ 1/100,100s	
Lens	4mm @ F2.0 (2.8mm, 6mm optional) Angle of view: 98.5°(2.8mm), 79°(4mm), 49°(6mm)	4mm @ F2.0 (2.8mm, 6mm optional) 2048 × 1536: Angle of view: 86°(2.8mm), 70°(4mm), 43.3°(6mm) 1920 × 1080: Angle of view: 98.5°(2.8mm), 79°(4mm), 49°(6mm)
Lens mount	M12	
Angle adjustment	Pan: 0° ~ 355°, Tilt: 0° ~ 65°, Rotation: 0 ~ 360°	
Digital noise reduction	3D DNR	
Wide dynamic range	Digital WDR	
Day & night	IR cut filter with auto switch	
Compression Standard		
Video compression	H.264 / MJPEG	
H.264 codec profile	Main profile	
Bit rate	32 Kbps ~ 16 Mbps	
Dual stream	Yes	
Image		
Max. Image Resolution	1920 x 1080	2048 x 1536
Frame rate	50Hz: 25fps (1920 × 1080), 25fps (1280 × 720) 60Hz: 30fps (1920 × 1080), 30fps (1280 × 720)	50Hz: 20fps (2048 × 1536), 25fps (1920 × 1080), 25fps (1280 × 720) 60Hz: 20fps (2048 × 1536), 30fps (1920 × 1080), 30fps (1280 × 720)
Image settings	Saturation, brightness, sharpness, contrast, sharpness adjustable through client software or web browser	
BLC	Yes, zone configurable	
ROI	Yes, up to 3 configurable areas	
Network		
Network storage	Local storage: Built-in Micro SD/SDHC/SDXC card slot, up to 64 GB ; NAS	
Alarm trigger	Face detection, line crossing detection, intrusion detection, scene change detection, Motion detection, Dynamic Analysis, Tampering alarm, Network disconnect, IP address conflict, Storage full, Storage error	
Protocols	TCP/IP, ICMP, HTTP, HTTPS, FTP, DHCP, DNS, DDNS, RTP, RTSP, RTCP, PPPoE, NTP, UPnP, SMTP, SNMP, IGMP, 802.1X, QoS, IPv6, Bonjour	
System compatibility	ONVIF, PSIA, CGI, ISAPI	
General functionalities	User Authentication, Watermark	
General function	Flickerless, dual stream, heartbeat, mirror, password protection, watermark	
Interface		
Communication Interface	1 RJ45 10M/100M Ethernet interface	
Wi-Fi Specification (Only for -W model)		
Wireless Standards	IEEE802.11b, 802.11g, 802.11n Draft	
Frequency Range	2.4 GHz ~ 2.4835 GHz	
Channel Bandwidth	20/40MHz Support	
Protocols	802.11b: CCK, QPSK, BPSK; 802.11g/n: OFDM	
Security	64/128-bit WEP, WPA/WPA2, WPA-PSK/WPA2-PSK, WPS	
Transmit Output Power	11b: 17±1.5dBm @ 11Mbps; 11g: 14±1.5dBm @ 54Mbps; 11n: 12.5±1.5dBm	
Receive Sensitivity	11b: -90dBm @ 11Mbps (Typical); 11g: -75dBm @ 54Mbps (Typical); 11n: -74dBm (Typical)	
Transfer Rates	11b: 11Mbps; 11g: 54Mbps; 11n: up to 150Mbps	
Wireless Range	Outdoor: 200m, Indoor: 50m; *The performance varies based on actual environment.	
Wireless Standards	IEEE802.11b, 802.11g, 802.11n Draft	
General		
Operating conditions	-30 °C ~ 60 °C (-22 °F ~ 140 °F); Humidity 95% or less (non-condensing)	
Power supply	12 V DC ± 10%; PoE (802.3af)	
Power consumption	Max. 5 W (Max. 7 W with IR cut filter on)	
Impact protection	IEC60068-2-75Eh, 20J; EN50102, up to IK10	
Ingress protection	IP66	
IR range	30 meters	
Dimensions	Φ111 × 82 (4.4" × 3.2")	
Weight	500g (1.1 lbs)	

DS-2CD2T22-13/-15/-18 (2.0MP) DS-2CD2T32-13/-15/-18 (3.0MP)

EXIR Bullet Network Camera



Key features

- 1.3MP / 3MP high resolution
- HD real-time video
- DWDR & 3D DNR
- EXIR illuminators: up to 80m
- IP66
- PoE
- Bracket included

Dimensions

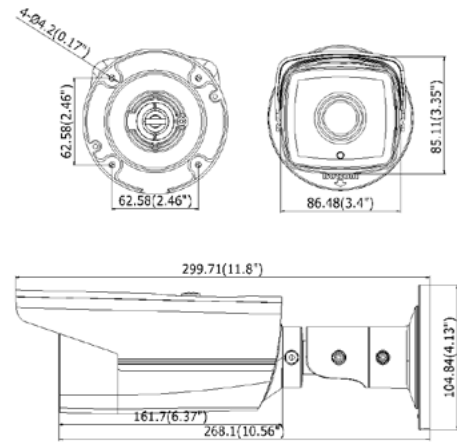

Available models

DS-2CD2T22-13, DS-2CD2T22-15, DS-2CD2T22-18
DS-2CD2T32-13, DS-2CD2T32-15, DS-2CD2T32-18

* 1.3MP model is also available -- DS-2CD2T12-13/15/18

	DS-2CD2T22-13/-15/-18	DS-2CD2T32-13/-15/-18
Camera		
Image sensor	1/3" Progressive Scan CMOS	
Min. illumination	0.01 Lux @(F1.2,AGC ON), 0 Lux with IR 0.014 Lux @(F1.4,AGC ON), 0 Lux with IR	0.07 Lux @(F1.2,AGC ON), 0 Lux with IR 0.1 Lux @(F1.4,AGC ON), 0 Lux with IR
Shutter time	1/3 s to 1/100,000 s	
Lens	4 mm @ F2.5 (6mm, 16mm optional) Angle of view: 80°	4 mm @ F2.5 (6mm, 16mm optional) Angle of view: 76.5°
Lens mount	M12	
Day & night	ICR	
Digital noise reduction	3D DNR	
Wide dynamic range	Digital WDR	
Compression Standard		
Video compression	H.264 / MJPEG	
H.264 codec profile	BaseLine Profile / Main Profile	
Bit rate	32 Kbps ~ 12 Mbps	
Dual Stream	Yes	
Image		
Max. Image Resolution	1920 X 1080	2048 x 1536
Frame rate	50 Hz: 25fps(1920 x 1080), 25 fps (1280 x 960), 25 fps (1280 x 720) 60 Hz: 25fps(1920 x 1080), 30 fps (1280 x 960), 30 fps (1280 x 720)	50Hz: 20fps (2048 x 1536), 25fps (1920 x 1080), 25fps (1280 x 720) 60Hz: 20fps (2048 x 1536), 30fps (1920 x 1080), 30fps (1280 x 720)
Image settings	Rotate mode, Saturation, Brightness, Contrast adjustable by client software or web browser	
Backlight compensation	Yes, zone optional	
ROI	Yes, up to 4 configurable areas	
Network		
Network storage	NAS	
Alarm trigger	Motion detection, tampering alarm, scene change detection, face detection, intrusion detection, Line crossing detection	
Protocols	TCP/IP, ICMP, HTTP, HTTPS, FTP, DHCP, DNS, DDNS, RTP, RTSP, RTCP, PPPoE, NTP, UPnP, SMTP, SNMP, IGMP, 802.1X, QoS, IPv6, Bonjour	
System compatibility	ONVIF, PSIA, CGI, ISAPI	
General functionalities	User Authentication, Watermark, IP address filtering, Anonymous access	
Interface		
Communication interface	1 RJ45 10M / 100M Ethernet interface	
Onboard storage	Built-in Micro SD/SDHC/SDXC card slot, up to 64 GB	
General		
Operating conditions	-30 °C ~ 60 °C (-22°F ~ 140 °F) humidity 95% or less (non-condensing)	
Power supply	12 VDC ± 10% , PoE (802.3af)	
Power consumption	-13: max. 5.5W -15: max. 7W -18: max 10W	-13: max. 5.5W -15: max. 7W -18: max 10W
Ingress protection level	IP66	
IR range	-13: 1pcs EXIR LED, up to 30m -15: 2pcs EXIR LEDs, up to 50m -18: 4pcs EXIR LEDs, up to 80m	
Dimensions	Φ105mmx300mm	
Weight	1200g	

DS-2CD2312-1 (1.3MP) DS-2CD2332-1 (3.0MP)

EXIR Turret Network Camera



Key features

- 1.3MP / 3MP high resolution
- HD real-time video
- 3D DNR & DWDR & BLC
- EXIR illuminator (up to 30m)
- IP66
- PoE

Dimensions

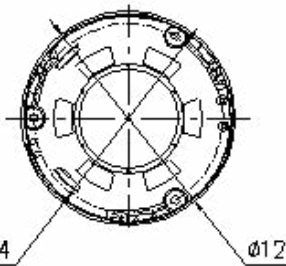
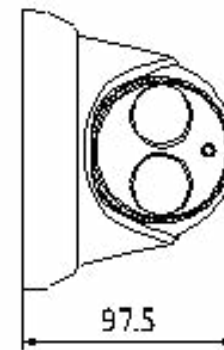

Available models

DS-2CD2312-1 (1.3MP)
DS-2CD2332-1 (3.0MP)

	DS-2CD2322-1	DS-2CD2332-1
Camera		
Image sensor	1/3" progressive scan CMOS	
Min. illumination	0.01 lux @F1.2, AGC ON, 0 lux with IR	0.07 lux @F1.2, AGC ON, 0 lux with IR
Shutter time	1/3s ~ 1/100,100s	
Lens	4mm @ F2.0 (2.8mm, 6mm optional) Angle of view: 98.5°(2.8mm), 79°(4mm), 49°(6mm)	4mm @ F2.0 (2.8mm, 6mm optional) 2048 x 1536: Angle of view: 86°(2.8mm), 70°(4mm), 43.3°(6mm) 1920 x 1080: Angle of view: 98.5°(2.8mm), 79°(4mm), 49°(6mm)
Lens mount	M12	
Angle adjustment	Horizontal: 0° ~ 360°, vertical: 0° ~ 75°, rotation: 0° ~ 360°	
Day & night	ICR	
Digital noise reduction	3D DNR	
Wide dynamic range	Digital WDR	
Backlight compensation	Yes, zone configurable	
Compression Standard		
Video compression	H.264 / MJPEG	
H.264 codec profile	Main profile	
Bit rate	32 Kbps ~ 16 Mbps	
Dual stream	Yes	
Image		
Max. Image Resolution	1280 x 960	2048 x 1536
Frame rate	50Hz: 25fps (1280 x 960), 25fps (1280 x 720) 60Hz: 30fps (1280 x 960), 30fps (1280 x 720)	50Hz: 20fps (2048 x 1536), 25fps (1920 x 1080), 25fps (1280 x 720) 60Hz: 20fps (2048 x 1536), 30fps (1920 x 1080), 30fps (1280 x 720)
Image settings	Saturation, brightness, sharpness, contrast, sharpness adjustable through client software or web browser	
Network		
Network storage	NAS	
Alarm trigger	Motion detection, line crossing detection, tampering alarm, scene change detection, face detection, intrusion detection	
Protocols	TCP/IP, ICMP, HTTP, HTTPS, FTP, DHCP, DNS, DDNS, RTP, RTSP, RTCP, PPPoE, NTP, UPnP, SMTP, SNMP, IGMP, 802.1X, QoS, IPv6, Bonjour	
System compatibility	ONVIF, PSIA, CGI	
General functionalities	User authentication, watermark	
Interface		
Communication interface	1 RJ45 10 M / 100 M Ethernet interface	
General		
Operating conditions	-30 °C ~ 60 °C (-22°F ~ 140 °F) humidity 95% or less (non-condensing)	
Power supply	12 VDC ± 10% , PoE (802.3af)	
Power consumption	Max. 5.5W (7.5W with ICR on)	
Weather proof rating	IP66	
EXIR range	Up to 30m	
Dimension	Φ 127 x 97.5 mm	
Weight	670g	

DS-2CD2422F-I(W) (2.0MP)

DS-2CD2432F-I(W) (3.0MP)

IR Cube Network Camera

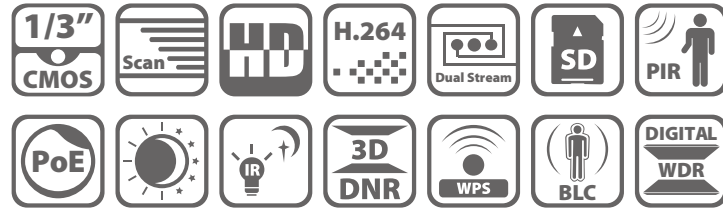

Key features

- 2MP / 3MP high resolution
- HD real-time video
- PIR detection
- IR LEDs (up to 10m)
- DWDR & 3D DNR & BLC
- PoE
- SD/SDHC/SDXC card slot (up to 64GB)
- Wi-Fi optional (WPS connection)

Dimensions

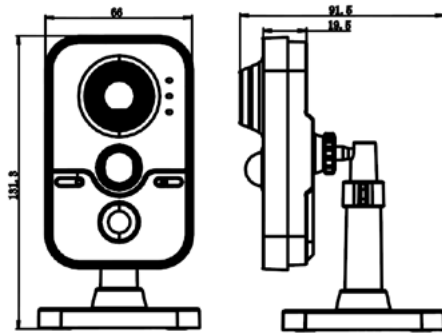

Available models

- DS-2CD2422F-I, DS-2CD2422F-IW
 DS-2CD2432F-I, DS-2CD2432F-IW
 * 1.3MP model is also available -- DS-2CD2412F-I(W)
 * -W: Wi-Fi

	DS-2CD2422F-I (W)	DS-2CD2432F-I (W)
Camera		
Image sensor	1/3" progressive scan CMOS	
Min. illumination	0.01 lux @F1.2, AGC ON, 0 lux with IR	0.07 lux @F1.2, AGC ON, 0 lux with IR
Shutter time	1/3s ~ 1/100,100s	
Lens	4mm@ F2.0 (2.8mm, 6mm optional) Angle of view: 98.5°(4mm), 79°(4mm), 49°(6mm)	4mm@ F2.0 (2.8mm, 6mm optional) 2048 x 1536: Angle of view: 86°(4mm), 70°(4mm), 43.3°(6mm) 1920 x 1080: Angle of view: 98.5°(4mm), 79°(4mm), 49°(6mm)
Lens mount	M12	
Day & night	ICR	
Digital noise reduction	3D DNR	
Wide dynamic range	Digital WDR	
Backlight compensation	Yes, zone configurable	
Compression Standard		
Video compression	H.264 / MJPEG	
H.264 codec profile	Main profile	
Bit rate	32 Kbps ~ 16 Mbps	
Audio compression	G.711 / G.726	
Audio bit rate	64 Kbps (G.711) / 16 Kbps (G.726)	
Image		
Max. Image Resolution	1920 x 1080	2048 x 1536
Frame rate	50Hz: 25fps (1920 x 1080), 25fps (1280 x 720) 60Hz: 30fps (1920 x 1080), 30fps (1280 x 720)	50Hz: 20fps (2048 x 1536), 25fps (1920 x 1080), 25fps (1280 x 720) 60Hz: 20fps (2048 x 1536), 30fps (1920 x 1080), 30fps (1280 x 720)
Image settings	Saturation, brightness, sharpness, contrast, sharpness adjustable through client software or web browser	
Network		
Network storage	NAS	
Alarm trigger	PIR detection, motion detection, line crossing detection, tampering alarm, network disconnect, IP address conflict, storage exception, storage error	
Protocols	TCP/IP, ICMP, HTTP, HTTPS, FTP, DHCP, DNS, DDNS, RTP, RTSP, RTCP, PPPoE, NTP, UPnP, SMTP, SNMP, IGMP, 802.1X, QoS, IPv6, Bonjour	
System compatibility	ONVIF, PSIA, CGI	
General functionalities	Flickerless, dual stream, heartbeat, mirror, user authentication, video mask, watermark	
Interface		
Communication interface	1 RJ45 10 M / 100 M Ethernet interface	
Onboard storage	Up to 64GB SD/SDHC/SDXC card slot	
Alarm I/O	1/1	
Wi-Fi parameters (only for -W model)		
Wi-Fi standard	IEEE802.11b/g/n	
Frequency range	2.4 GHz ~ 2.4835 GHz	
Communication bandwidth	Support 20/40 MHz	
Security	64/128-bit WEP, WPA/WPA2, WPA-PSK/WPA2-PSK, WPS	
Transmission rate	11b: 11Mbps, 11g: 54Mbps, 11n: 150Mbps	
Transmission range	Outdoor: 200m, Indoor: 50m (The performance varies based on actual environment.)	
General		
Operating conditions	-30 °C ~ 60 °C (-22°F ~ 140 °F) humidity 95% or less (non-condensing)	
Power supply	12 VDC ± 10% , PoE (802.3af)	
Power consumption	Max. 5W	
PIR	Up to 10m, max. detection angle: 80°	
IR range	Max. 10m	
Dimension	66x91.5x131.3(2.60"x3.60"x5.17")	
Weight	400g	

DS-2CD2522F-I(S) (2.0MP)

DS-2CD2532F-I(S) (3.0MP)

IR Mini Dome Network Camera

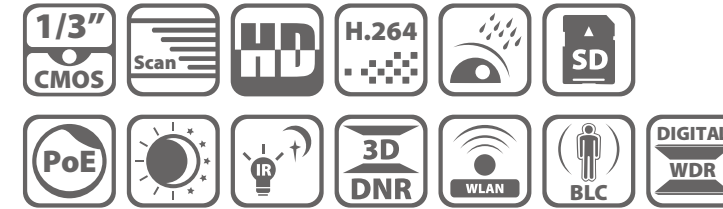

Key features

- 2MP / 3MP high resolution
- HD real-time video
- IR LEDs (up to 10m)
- DWDR & 3D DNR & BLC
- Onboard storage (up to 64GB)
- -S: Audio/Alarm IO
- IP66 protection
- Built-in Mic

Dimensions

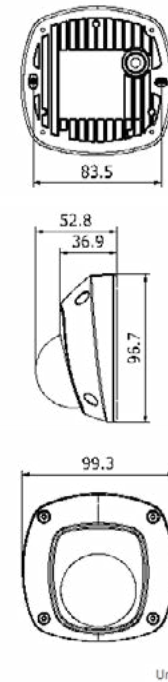

Available models

- DS-2CD2522F-I, DS-2CD2522F-IS
 DS-2CD2532F-I, DS-2CD2532F-IS
 * 1.3MP model is also available -- DS-2CD2512F-I(S)
 * -S: Audio/Alarm IO

	DS-2CD2522F-I (S)	DS-2CD2532F-I (S)
Camera		
Image sensor	1/3" progressive scan CMOS	
Min. illumination	0.01 lux @F1.2, AGC ON, 0 lux with IR	0.07 lux @F1.2, AGC ON, 0 lux with IR
Shutter time	1/3s ~ 1/100,100s	
Lens	4mm @ F2.0 (2.8mm, 6mm optional) Angle of view: 98.5°(2.8mm), 79°(4mm), 49°(6mm)	4mm @ F2.0 (2.8mm, 6mm optional) 2048 x 1536: Angle of view: 86°(2.8mm), 70°(4mm), 43.3°(6mm) 1920 x 1080: Angle of view: 98.5°(2.8mm), 79°(4mm), 49°(6mm)
Lens mount	M12	
Day & night	ICR	
Adjustment angle	Horizontal: ±30°, vertical: 0~75°, rotation: 0~360°	
Digital noise reduction	3D DNR	
Wide dynamic range	Digital WDR	
Backlight compensation	Yes, zone configurable	
Compression Standard		
Video compression	H.264 / MJPEG	
H.264 codec profile	Main profile	
Bit rate	32 Kbps ~ 16 Mbps	
Audio compression (-S)	G.711 / G.726 / MP2L2	
Audio bit rate (-S)	64 Kbps (G.711) / 16 Kbps (G.726) / 32~128Kbps (MP2L2)	
Image		
Max. Image Resolution	1920 x 1080	2048 x 1536
Frame rate	50Hz: 25fps (1920 x 1080), 25fps (1280 x 720) 60Hz: 30fps (1920 x 1080), 30fps (1280 x 720)	50Hz: 20fps (2048 x 1536), 25fps (1920 x 1080), 25fps (1280 x 720) 60Hz: 20fps (2048 x 1536), 30fps (1920 x 1080), 30fps (1280 x 720)
Image settings	Saturation, brightness, sharpness, contrast, sharpness adjustable through client software or web browser	
Network		
Network storage	NAS	
Alarm trigger	Motion detection, line crossing detection, tampering alarm, scene change detection, face detection, intrusion detection	
Protocols	TCP/IP, ICMP, HTTP, HTTPS, FTP, DHCP, DNS, DDNS, RTP, RTSP, RTCP, PPPoE, NTP, UPnP, SMTP, SNMP, IGMP, 802.1X, QoS, IPv6, Bonjour	
System compatibility	ONVIF, PSIA, CGI	
General functionalities	Flickerless, dual stream, heartbeat, mirror, user authentication, video mask, watermark	
Interface		
Communication interface	1 RJ45 10M / 100M ethernet port	
On-board storage	Built-in Micro SD/SDHC/SDXC card slot, up to 64 GB	
Alarm interface	-S: 1/1 alarm I/O	
General		
Operating conditions	-30 °C ~ 60 °C (-22°F ~ 140 °F) humidity 95% or less (non-condensing)	
Power supply	12 VDC ± 10% , PoE (802.3af)	
Power consumption	Max. 5W	
Ingress protection level	IP66	
Impact Protection	IEC60068-275Eh, 50J; EN50102, up to IK08	
IR range	Up to 10m	
Dimensions (mm)	99.3x96.7x52.8mm	
Weight	600 g	

DS-2CD2622F-I (S) (2.0MP)

DS-2CD2632F-I (S) (3.0MP)

VF IR Bullet Network Camera

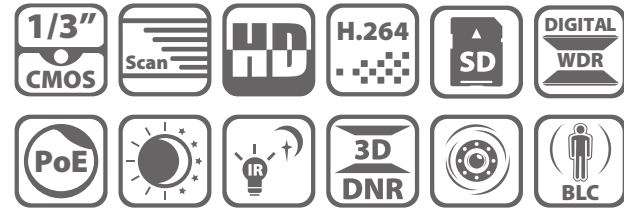

Key features

- 2MP / 3MP high resolution
- HD real-time video
- Vari-focal lens
- IR LEDs (up to 30m)
- DWDR & 3D DNR & BLC
- IP66
- Onboard storage (up to 64GB)
- (-S) Audio I/O, Alarm I/O

Dimensions

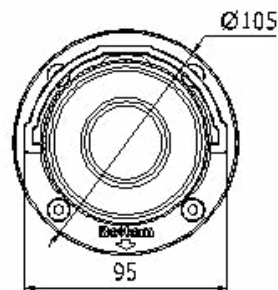
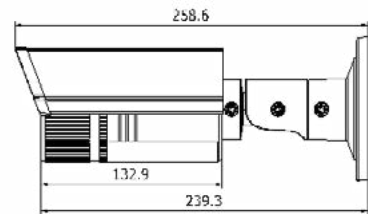

Unit: mm

Available models

DS-2CD2622F-I, DS-2CD2622F-IS

DS-2CD2632F-I, DS-2CD2632F-IS

* 1.3MP model is also available -- DS-2CD2612F-I(S)

- * -S: 1-ch audio I/O interface
1-ch alarm I/O interface

	DS-2CD2622F-I (S)	DS-2CD2632F-I (S)
Camera		
Image sensor	1/3" progressive scan CMOS	
Min. illumination	0.01 lux @F1.2, AGC ON, 0.014 lux@F1.4, AGC ON, 0 lux with IR	0.07 lux @F1.2, AGC ON, 0.1 lux@F1.4, AGC ON, 0 lux with IR
Shutter time	1/3s ~ 1/100,100s	
Lens	2.8 ~ 12 mm @F1.4, angle of view: 105.2°~31.9°	2.8 ~ 12 mm @F1.4, angle of view: 91.2°~28.3°
Lens mount	Φ14	
Day & night	ICR	
Digital noise reduction	3D DNR	
Wide dynamic range	Digital WDR	
Backlight compensation	Yes, zone configurable	
Compression Standard		
Video compression	H.264 / MJPEG	
H.264 codec profile	Main profile	
Bit rate	32 Kbps ~ 16 Mbps	
Audio compression (-S)	G.711 / G.726 / MP2L2	
Audio bit rate (-S)	64 Kbps (G.711) / 16 Kbps (G.726) / 32-128 Kbps (MP2L2)	
Image		
Max. Image Resolution	1920 x 1080	2048 x 1536
Frame rate	50Hz: 25fps (1920 x 1080), 25fps (1280 x 720) 60Hz: 30fps (1920 x 1080), 30fps (1280 x 720)	50Hz: 20fps (2048 x 1536), 25fps (1920 x 1080), 25fps (1280 x 720) 60Hz: 20fps (2048 x 1536), 30fps (1920 x 1080), 30fps (1280 x 720)
Image settings	Saturation, brightness, contrast, sharpness adjustable through client software or web browser	
Network		
Network storage	NAS	
Alarm trigger	Motion detection, line crossing detection, Tampering alarm, Network disconnect, IP address conflict, Storage full, Storage error	
Protocols	TCP/IP, ICMP, HTTP, HTTPS, FTP, DHCP, DNS, DDNS, RTP, RTSP, RTCP, PPPoE, NTP, UPnP, SMTP, SNMP, IGMP, 802.1X, QoS, IPv6, Bonjour	
System compatibility	ONVIF, PSIA, CGI	
General functionalities	User authentication, watermark, dual stream	
Interface		
Communication interface	1 RJ45 10 M / 100 M Ethernet port	
Onboard storage	Built-in Micro SD / SDHC / SDXC card slot, up to 64 GB	
General		
Operating conditions	-30 °C ~ 60 °C (-22°F ~ 140 °F) humidity 95% or less (non-condensing)	
Power supply	12 VDC ± 10%, PoE (802.3af)	
Power consumption	Max. 5.5W (7.5W with ICR on)	
Ingress protection level	IP66	
IR range	Up to 30m	
Dimensions	95 x 105 x 258.6 mm	
Weight	1200g	

DS-2CD2722F-I (S) (2.0MP)

DS-2CD2732F-I (S) (3.0MP)

VF IR Dome Network Camera

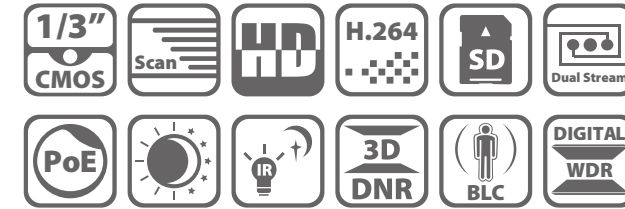

Key features

- 2MP / 3MP high resolution
- HD real-time video
- IR LEDs: up to 30m
- DWDR & 3D DNR & BLC
- Onboard storage (up to 64GB)
- (-S) Audio I/O, Alarm I/O
- IP66
- Vandal-proof

Dimensions

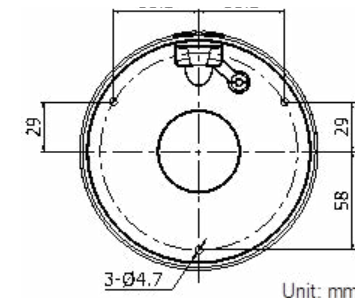
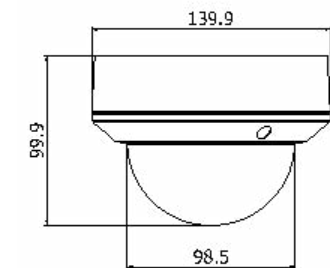

Unit: mm

Available models

DS-2CD2722F-I, DS-2CD2722F-IS

DS-2CD2732F-I, DS-2CD2732F-IS

* 1.3MP model is also available -- DS-2CD2712F-I(S)

- * -S: Audio I/O interface
Alarm I/O interface.

	DS-2CD2722F-I (S)	DS-2CD2732F-I (S)
Camera		
Image sensor	1/3" progressive scan CMOS	
Min. illumination	0.01 lux @F1.2, AGC ON, 0.014 lux @F1.4, AGC ON, 0 lux with IR	0.07 lux @F1.2, AGC ON, 0.1 lux @F1.4, AGC ON, 0 lux with IR
Shutter time	1/3s ~ 1/100,100s	
Lens	2.8 ~ 12 mm @F1.4, angle of view: 105.2°~31.9°	2.8 ~ 12 mm @F1.4, angle of view: 91.2°~28.3°
Lens mount	Φ14	
Auto iris	DC drive	
Day & night	ICR	
Digital noise reduction	3D DNR	
Wide dynamic range	Digital WDR	
Backlight compensation	Yes, zone configurable	
Angle adjustment	Pan: 0° ~ 355°, tilt: 0° ~ 75°, rotation: 0° ~ 355°	
Compression Standard		
Video compression	H.264 / MJPEG	
H.264 codec profile	Main profile	
Bit rate	32 Kbps ~ 16 Mbps	
Audio compression (-S)	G.711 / G.726	
Audio bit rate (-S)	64 Kbps (G.711) / 16 Kbps (G.726)	
Image		
Max. Image Resolution	1920 x 1080	2048 x 1536
Frame rate	50Hz: 25fps (1920 x 1080), 25fps (1280 x 720) 60Hz: 30fps (1920 x 1080), 30fps (1280 x 720)	50Hz: 20fps (2048 x 1536), 25fps (1920 x 1080), 25fps (1280 x 720) 60Hz: 20fps (2048 x 1536), 30fps (1920 x 1080), 30fps (1280 x 720)
Image settings	Saturation, brightness, contrast, sharpness adjustable through client software or web browser	
Network		
Network storage	NAS	
Alarm trigger	Motion detection, line crossing detection, tampering alarm, scene change detection, face detection, intrusion detection	
Protocols	TCP/IP, ICMP, HTTP, HTTPS, FTP, DHCP, DNS, DDNS, RTP, RTSP, RTCP, PPPoE, NTP, UPnP, SMTP, SNMP, IGMP, 802.1X, QoS, IPv6, Bonjour	
System compatibility	ONVIF, PSIA, CGI	
General functionalities	User authentication, watermark, dual stream	
Interface		
Communication interface	1 RJ45 10 M / 100 M Ethernet interface	
Onboard storage	Built-in Micro SD / SDHC / SDXC card slot, up to 64 GB	
General		
Operating conditions	-30 °C ~ 60 °C (-22°F ~ 140 °F) humidity 95% or less (non-condensing)	
Power supply	12 VDC ± 10%, PoE (802.3af)	
Power consumption	Max. 5.5W (max. 7W with ICR on)	
Impact protection	IEC60068-2-75Eh, 50J; EN50102, up to IK10	
Ingress protection level	IP66	
IR range	Up to 30m	
Dimensions	Φ 140 x 99.9 mm	
Weight	1000g	

DS-2CD2212-I5 (1.3MP) DS-2CD2232-I5 (3.0MP)

EXIR Bullet Network Camera

Also Available

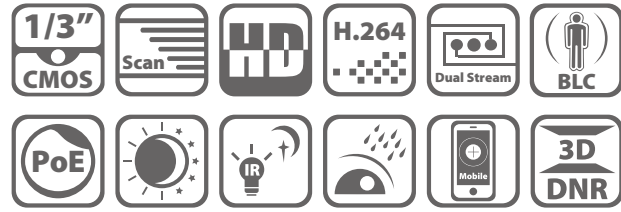

Key features

- 1.3MP / 3MP high resolution
- HD real-time video
- DWDR & 3D DNR
- EXIR illuminators: up to 50m
- IP66
- PoE
- Bracket included

Dimensions

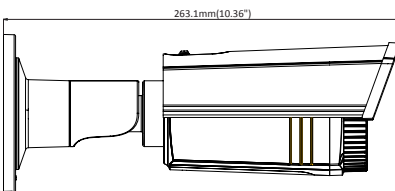
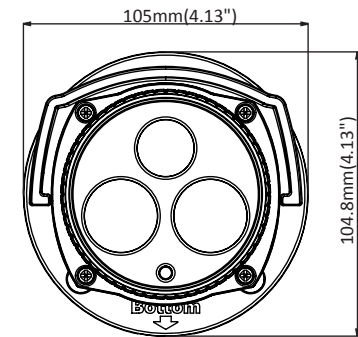

	DS-2CD2222-I5	DS-2CD2232-I5
Camera		
Image sensor	1/3" progressive scan CMOS	
Min. illumination	0.01 lux @F1.2, AGC ON, 0 lux with IR	0.07 lux @F1.2, AGC ON, 0 lux with IR
Shutter time	1/3s ~ 1/100,100s	
Lens	4mm@ F2.0 (6mm, 12mm optional) Angle of view: 79°(4mm), 49°(6mm), 23.2°(12mm)	4mm@ F2.0 (6mm, 12mm optional) 2048 x 1536: Angle of view: 70°(4mm), 43.3°(6mm), 20.6°(12mm) 1920 x 1080: Angle of view: 79°(4mm), 49°(6mm), 23.2°(12mm)
Lens mount	M12	
Day & night	ICR	
Digital noise reduction	3D DNR	
Wide dynamic range	Digital WDR	
Backlight compensation	Yes, zone configurable	
Compression Standard		
Video compression	H.264 / MJPEG	
H.264 codec profile	Main profile	
Bit rate	32 Kbps ~ 16 Mbps	
Dual stream	Yes	
Image		
Max. Image Resolution	1280 x 960	2048 x 1536
Frame rate	50Hz: 25fps (1280 x 960), 25fps (1280 x 720) 60Hz: 30fps (1280 x 960), 30fps (1280 x 720)	50Hz: 20fps (2048 x 1536), 25fps (1920 x 1080), 25fps (1280 x 720) 60Hz: 20fps (2048 x 1536), 30fps (1920 x 1080), 30fps (1280 x 720)
Image settings	Saturation, brightness, sharpness, contrast, sharpness adjustable through client software or web browser	
Network		
Network storage	NAS	
Alarm trigger	Motion detection, line crossing detection, tampering alarm, scene change detection, face detection, intrusion detection	
Protocols	TCP/IP, ICMP, HTTP, HTTPS, FTP, DHCP, DNS, DDNS, RTP, RTSP, RTCP, PPPoE, NTP, UPnP, SMTP, SNMP, IGMP, 802.1X, QoS, IPv6, Bonjour	
System compatibility	ONVIF, PSIA, CGI	
General functionalities	User authentication, watermark	
Interface		
Communication interface	1 RJ45 10 M / 100 M Ethernet interface	
General		
Operating conditions	-30 °C ~ 60 °C (-22°F ~ 140 °F) humidity 95% or less (non-condensing)	
Power supply	12 VDC ± 10% , PoE (802.3af)	
Power consumption	Max. 7W (max. 9W with ICR on)	
Weather proof rating	IP66	
EXIR range	Up to 50m	
Dimension	105 x 104.8 x 263.1 mm	
Weight	700g	

Available models

- DS-2CD2212-I5 (1.3MP)
- DS-2CD2232-I5 (3.0MP)

PoE NVR



DS-7604/08/16NI-SE/P Embedded 1U PoE NVR

- 20/40/60Mbps Bit Rate Input Max(up to 4/8/16-ch IP video)
- Third-party network cameras supported
- Up to 5 Megapixels resolution recording
- HDMI and VGA output at up to 1920x1080P resolution
- 4 independent PoE network interfaces for Plug & Play
- 2 SATA, 2 USB2.0



DS-7616NI-ST(SP) Embedded 1U Plug & Play NVR

- 40Mbps Bit Rate Input Max(up to 16/32-ch IP video)
- Third-party network cameras supported
- Up to 5 Megapixels resolution recording
- HDMI and VGA output at up to 1920x1080P resolution
- 2 SATA, 3 USB2.0
- *-SP series support 8 independent PoE network interfaces for Plug & Play



DS-7604NI-E1(-E1/4P) Embedded 1U PoE NVR

- 25Mbps Bit Rate Input Max(up to 4-ch IP video)
- Third-party network cameras supported
- Up to 5 Megapixels resolution recording
- HDMI and VGA output at up to 1920x1080P resolution
- 4 independent PoE network interfaces for Plug & Play
- 1 SATA, 2 USB2.0



DS-7608/16NI-E2(-E2/8P) Embedded 1U PoE NVR

- 50/100Mbps Bit Rate Input Max(up to 8/16-ch IP video)
- Third-party network cameras supported
- Up to 5 Megapixels resolution recording
- HDMI and VGA output at up to 1920x1080P resolution
- 8 independent PoE network interfaces for Plug & Play
- 2 SATA, 2 USB2.0

Typical Commercial Applications: Clothing Store

Small and medium-sized enterprises have their own unique set of business needs that Hikvision's new 2-Line Network Camera series can fulfill. Take your pick for high-quality performance and reliable full-HD IP surveillance!

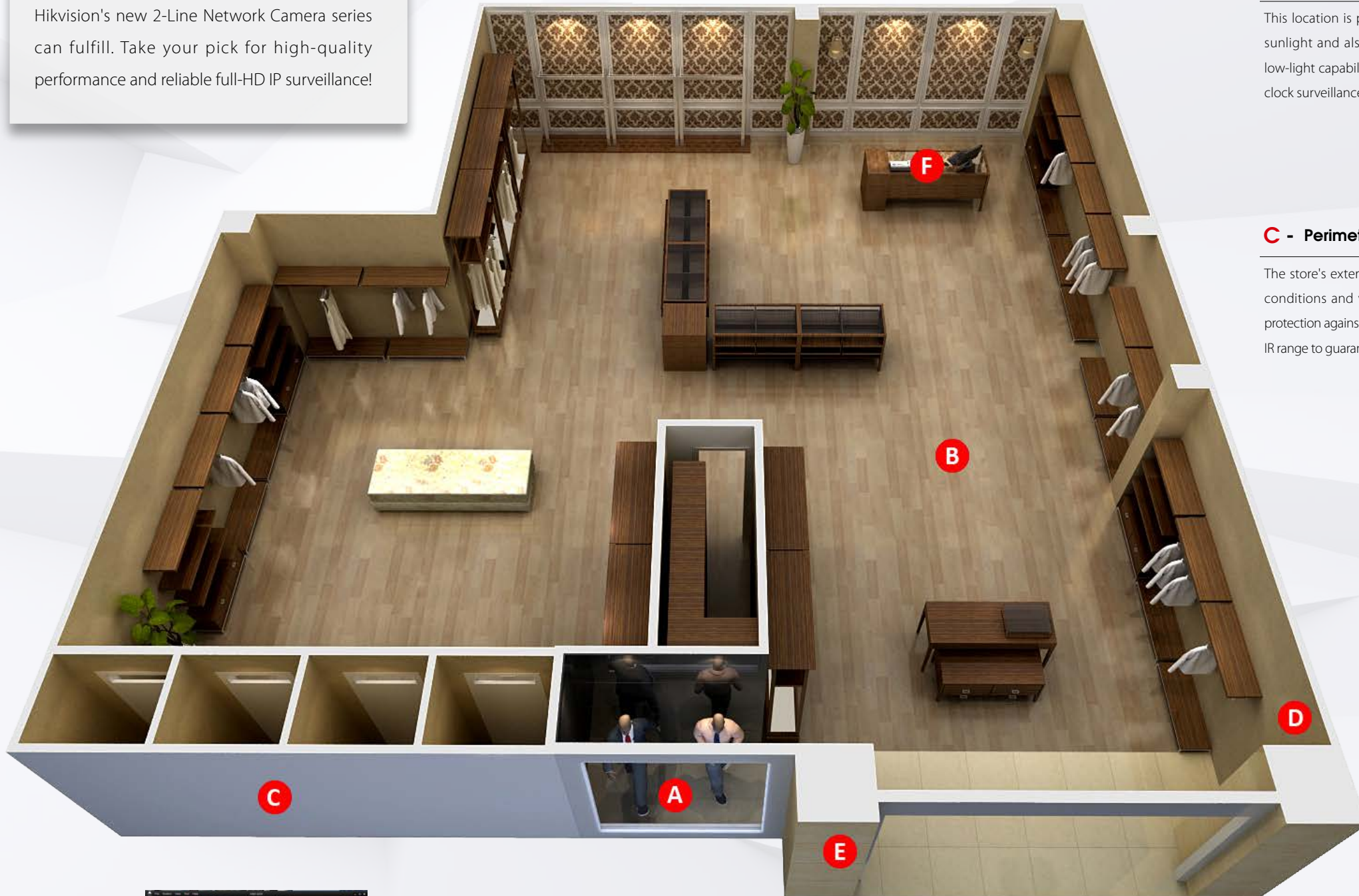

A - Window Display



This location is particularly vulnerable to strong sunlight and also requires a camera with good low-light capability in order to ensure around the clock surveillance.

B - Sales Floor



Unobtrusive aesthetics are crucial for a clothing store, especially one with private fitting rooms. A compact camera is a must to safeguard this kind of location.

C - Perimeter



The store's exterior is vulnerable to bad weather conditions and vandalism, requiring high-rated protection against weather and a high-performance IR range to guarantee nighttime safety.

D - Interior Wall



Often a camera needs to blend in with the store's interior but also maintain a right angle to the surface it's mounted on. Three-axis adjustment is an extremely useful feature for this scenario.

E - Entrance



The store's entrance is the most vulnerable to severe crimes such as violent break-ins, so a vandal-proof feature is imperative. In addition, the intrusion detection feature can trigger an alarm when a vehicle is parked in a specified area in front of the store.

F - Point of Sale as a "Control Room"



The POS is a critical location for crimes such as theft or robbery. A well-rounded system that includes a versatile camera with audio/alarm, human detection, and intrusion detection is a perfect fit.

An embedded NVR keeps the entire CCTV system highly efficient. Take advantage of its winning combination of reliability, HD performance, true plug and play, PoE, and automatic configuration of IP address.

Remote Video Management

Hikvision's iVMS-4200/4500 video management software can be installed on a smartphone or tablet. This gives users the advantage of checking in on their secure location anytime and anywhere.





iVMS-4200

Client Software

- Supports all Hikvision devices such as cameras, DVRs, DVS, etc.
- Provides flexible solutions by using different modules
- Supports HD devices
- User-friendly, intuitive interface
- Offers ability to manage channels by group
- Includes brief instruction for each module
- Can display multiple views and screens



iVMS-4500

Mobile Phone Software

- Supports all Hikvision devices such as cameras, DVRs, DVS, etc.
- Installed on smartphone or tablet
- Supports HD devices
- User-friendly, intuitive interface
- Supports Windows mobile, iPhone, Android, and Symbian OS

Accessories Selection



DS-2CD2112-I)
DS-2CD2132-I)



DS-1259ZJ
Inclined ceiling mount (Plastic)



DS-1258ZJ
Wall mount (Plastic)



DS-1272ZJ-110
Wall mount



DS-1272ZJ-110B
Wall mount with power intake box



DS-2CD2212-I5
DS-2CD2232-I5



DS-1214ZJ
Horizontal pole mount



DS-1215ZJ
Vertical pole mount



DS-1260ZJ
Power intake box



DS-2CD2312-I
DS-2CD2332-I



DS-1273ZJ-130-TRL
Wall mount



DS-1273ZJ-130B-TRL
Wall mount with power intake box



DS-2CD2612F-I(S)
DS-2CD2632F-I(S)



DS-1260ZJ
Power intake box



DS-2CD2712F-I(S)
DS-2CD2732F-I(S)



DS-1273ZJ-135
Wall mount



DS-1273ZJ-135B
Wall mount with power intake box

Free Tools from Hikvision



SADP



Bandwidth Calculator



Storage Calculator



NVR Channel Calculator



Local Playback



Focus Assistant



Calculation Tool



Lens Selector



Hikvision Tools



Hikvision USA

Tel: +1-909-895-0400

Email: sales@hikvisionusa.com

Hikvision Europe

Tel: +31-23-5542770

Email: saleseuro@hikvision.com

Hikvision Middle East

Tel: +971-4-8847628

Email: salesme@hikvision.com

Hikvision Russia

Tel: +7-812-313-19-63

Email: salesru@hikvision.com

Hikvision India

Tel: +91-22-28469900

Email: sales@pramahikvision.com

Hikvision Italy

Tel: +39-0438-6902

Email: info.it@hikvision.com

Hikvision France

Tel: +33(0)1-85-330-450

Email: info.fr@hikvision.com

Hikvision Spain

Tel: +34 91 737 1655

Email: info.es@hikvision.com

Hikvision Singapore

Tel: +65 6684 4718

Email: sg@hikvision.com

Hikvision Oceania

Tel: +61 2 8599 4233

Email: salesau@hikvision.com

Hikvision Hong Kong

Tel: +852-2151-1761

Email: sales@hikvision.com

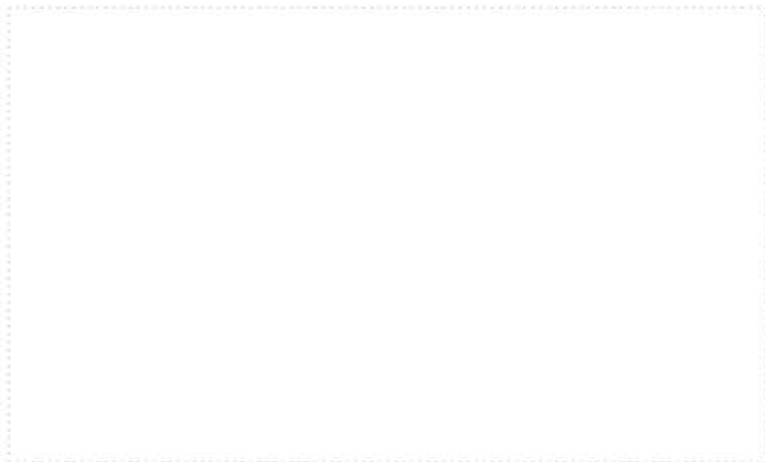

Headquarters

No.555 Qianmo Road, Binjiang District, Hangzhou, China

Tel: +86-571-8807-5998 Fax: +86-571-8993-5635

Email: overseasbusiness@hikvision.com

Technical Support: support@hikvision.com